

FOR SUBLEASE



1555 Poydras
New Orleans, Louisiana



Great Opportunity on Two (2) Separate Floors

Location:

1555 Poydras Street (across from the Superdome)

Size:

Floor 15 - 11,834 RSF

Floor 20 - 15,445 RSF

Tulane University Master Lease Expires:

June 30, 2017

Commission:

Four percent (4%) to sub-tenant's broker

Availability:

Immediately

Comments:

- Floor 15 can be divided into smaller suites
- Elevator lobby exposure
- Both spaces are built-out (see plans on reverse)
- Plenty of parking
- Will consider short term or long term sublease



*For subleasing pricing, lease details,
& to arrange a tour, please contact:*



CORPORATE REALTY

Mike Siegel
504-581-5005
msiegel@corp-realty.com

The information contained herein has been obtained from sources that we deem reliable. No representation or warranty is made as to the accuracy thereof, and it is submitted subject to errors, omissions, change of price, or other conditions, or withdrawal without notice.

FLOOR PLANS

FLOOR 15

(11,834 rsf)

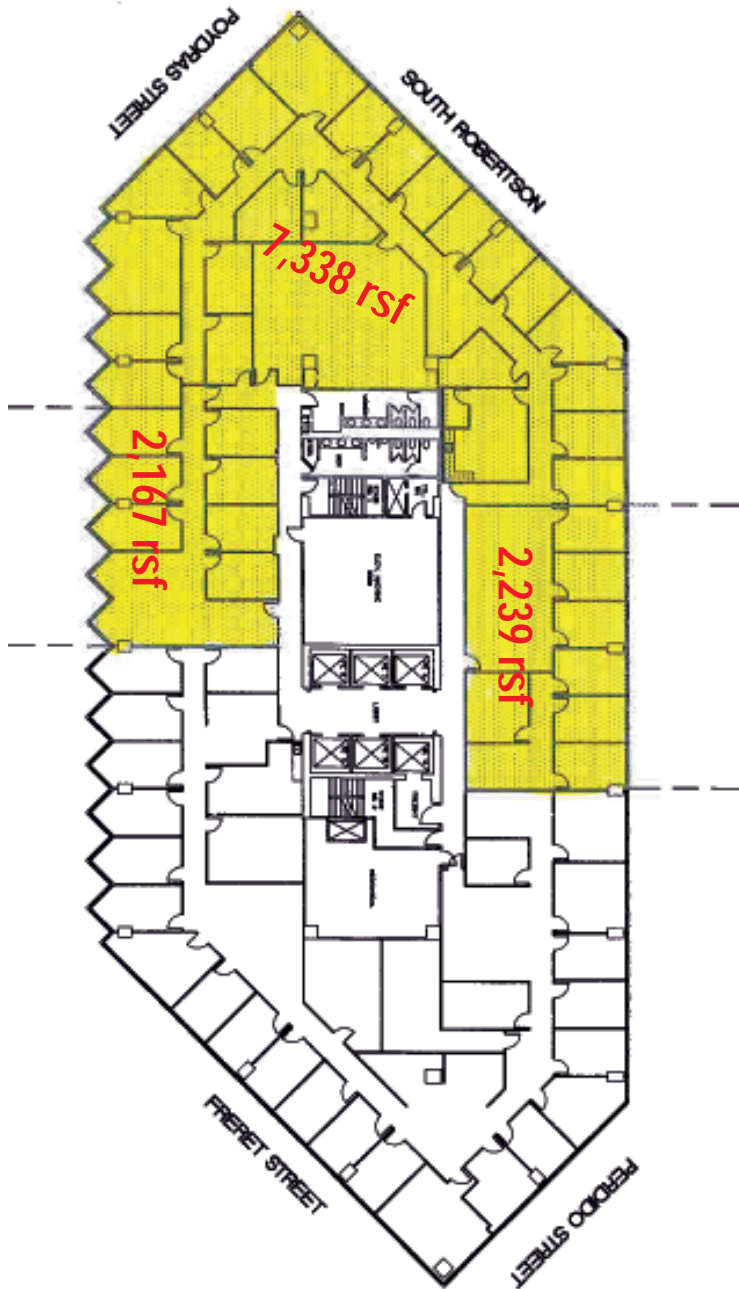

FLOOR 20

(15,445 rsf)

