

For Lease



300 Lafayette Street New Orleans, Louisiana

Size: Up to 1,975 rsf
(Minimum 724 rsf)

Rate: \$13.00 - \$15.00 prsf (gross lease)

Availability: Immediate

Comments:

- Great ground floor office space for lease
- Already built-out
- Wonderful window offices with high visibility
- Space in move-in condition (except for demising wall)

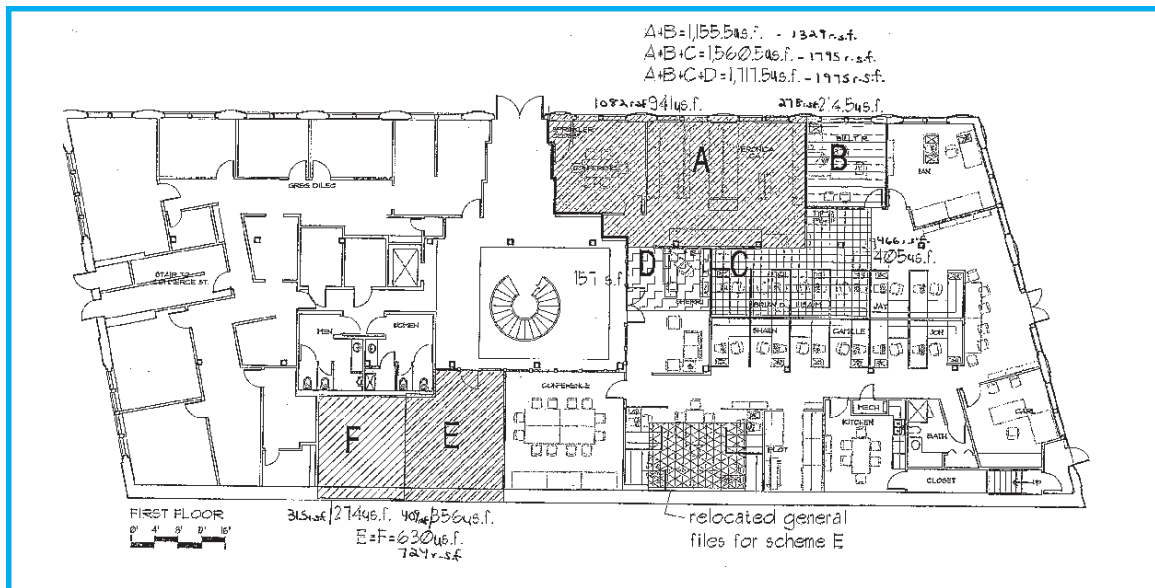

For Information:
Andrea Arons Huseman, CCIM
504-587-1450 / 504-587-1453 (fax)
ahuseman@corp-realty.com



CORPORATE REALTY

The information contained herein has been obtained from sources that we deem reliable. No representation or warranty is made as to the accuracy thereof, and it is submitted subject to errors, omissions, change of price, or other conditions, or withdrawal without notice.